

CPTU-50 DPSH-50

Gr. 50
6172547.65
320052.07

CPTU-1 DPSH-1

Gr. 1
6172606.82
320312.79

CPTU-2 DPSH-2

Gr. 2
6172576.35
320279.65

CPTU-4 DPSH-4

Gr. 4
6172522.19
320220.81

CPTU-5 DPSH-5

Gr. 5
6,172,471.43
320165.59

CPTU-6 DPSH-6

Gr. 6
617,242.18
320,159.73

CPTU-49 DPSH-49

Gr. 49
6172389.19
320,052.65

CPTU-7 DPSH-7

Gr. 7
6172372.12
320153.87

CPTU-8 DPSH-8

Gr. 8
6172322.47
320148.01

CPTU-9 DPSH-9

Gr. 9
6172272.81
320142.14

CPTU-10 DPSH-10

Contract symbols

- 6172606.82
320312.79 - Borehole location coordinates and its No.
- CPTU-1 - Location of the structural sounding survey
- DPSH-1 - Dynamic probing test site
- I'- Geological-lithological section line and its No.

SWECO			
RESEARCH SUPERVISOR	JUSTINAS CEINA	March 3, 2025	
RESEARCHER	JUSTINAS CEINA	March 3,	
RESEARCHER	LINA DABANTENI	March 3, 2025	
GT	Client: Klaipeda State Seaport Authority		

DRAWING NO. 1	
Design engineering geological and geotechnical investigations classified as Geotechnical Category III for the preparation of a project for the construction of new quays and shore reinforcements in the southern part of the port, dredging works, report.	
DESIGN ENGINEERING GEOLOGICAL SURVEYS	
Construction of new quays and shore reinforcements in the southern part of the port, dredging	ISSUE 0
For the preparation of the construction project, the design engineering geological and geotechnical studies are classified as Geotechnical Category III, report.	
MATERIALS LIST	
SCALE 1:2000	
PAGE 1	SHEETS 9

6172259.01
319,816.27

III

CPTU-44 DPSH-44

IV
Gr. 44
6172206.37
319971.54

320142.14

CPTU-10 DPSH-10

Gr. 10
6172223.16
320136.28

CPTU-11 DPSH-11

Gr. 11
6172173.50
320130.42

CPTU-12 DPSH-12

Gr. 12
6172125.32
320126.07

CPTU-43 DPSH-43

Gr. 43
6172106.65
319,723.00

CPTU-13 DPSH-13

Gr. 13
6172065.72
320107.20

CPTU-14 DPSH-14

Gr. 14
6172024.54
11284

CPTU-42 DPSH-42

Gr. 42
6,172,004.68
319,985.19

CPTU-15 DPSH-15

Gr. 15
6171999.42
320121.16

CPTU-40 DPSH-40

XIII
XII'
Gr. 40
6171920.03
319,794.91

CPTU-16 DPSH-16

Gr. 16
6171914.62
320090.37

CPTU-17 DPSH-17

Gr. 17

6171875.59
203400195.25

PAGE PAGES ISSUE

2 9 0

ED BUOY
G. 35

DGE
6.5
m

M 6171875.59		
203400195.25		
PAGE	PAGES	ISSUE
2	9	0

ACCESS CH

NEW LIGHTED
NO 37 FL. G. S

DREDGE
16.5m

CPTU-36 DPSH-36
Gr. 36
6171522.70
319751.60

CPTU-38 DPSH-38
Gr. 38
6171721.61
319,772.63

XII
6171920.03
319794.91

CPTU-39 DPSH-39
Gr. 39
6171608.36
319,937.44
IV

CPTU-41 DPSH-41
Gr. 41
6171806.68
319961.07

CPTU-24 DPSH-24
Gr. 24
6171527.98

CPTU-25 DPSH-25

CPTU-23 DPSH-23
Gr. 23
6,171,577.63
320,060.08

CPTU-22 DPSH-22
Gr. 22
6,171,627.29
320,065.95

CPTU-21 DPSH-21
Gr. 21
6,171,676.97
320071.80

CPTU-20 DPSH-20
Gr. 20
6171726.63
320,077.67

CPTU-19 DPSH-19
Gr. 19
6,171,776.29
320083.53

CPTU-18 DPSH-18
Gr. 18
6,171,825.94
320,089.39

CPTU-17 DPSH-17
Gr. 17
6171875.59
320095.25
VIII
320090.37

M321:020005
04.22
24094-GT1

PAGE	PAGES	ISSUE
3	9	0

NEW LIGHTED BUOY
NO 39 FLS 35

CPTU-36 DPSH-36
Gr. 36
6,171,522.70
319,751.60

CPTU-24 DPSH-24
Gr. 24
617,152.79
320,054.22

CPTU-25 DPSH-25
Gr. 25
6,171,478.32
320,048.35

CPTU-26 DPSH-26
Gr. 26
6,171,428.65
320,042.49

CPTU-37 DPSH-37
Gr. 37
6171408.73
319916.15

CPTU-27 DPSH-27
Gr. 27
6,171,379.02
320,036.63

CPTU-35 DPSH-35
Gr. 35
6171323.94
319,731.17

CPTU-28 DPSH-28
Gr. 28
6171329.36
320,030.77

CPTU-3 DPSH-3
Gr. 3
6171293.13
319835.71

CPTU-29 DPSH-29
Gr. 29
6171279.72
320,024.92

CPTU-34 DPSH-34
Gr. 34
6,171,263.26
319875.81

CPTU-30 DPSH-30
Gr. 30
6171230.08
320,019.05

CPTU-33 DPSH-33
Gr. 33
6171233.06
319,915.65

CPTU-32 DPSH-32
Gr. 32
6171202.70
319955.36

CPTU-31 DPSH-31
Gr. 31
6171180.46
320,013.18

Scale
1:2000
24094-GT1

PAGE	PAGE	ISSUE
4	9	0

X 319571.41

CPTU-48 DPSH-48

Gr. 48
6172430.88
319835.38

CPTU-49 DPSH-49

Gr. 49
6172389.19
320052.65

CPTU-46 DPSH-46

Gr. 46
6172295.20
319,656.39

CPTU-45 DPSH-45

Gr. 45
6,172,259.01
319,816.27
III

CPTU-44 DPSH-44

Gr. 44
6172206.37
319,971.54
IV

CPTU-43 DPSH-43

Gr. 43
6,172,106.65
319,723.00

NEW LIGHTED BUOY
NO 35 FL. G. 035

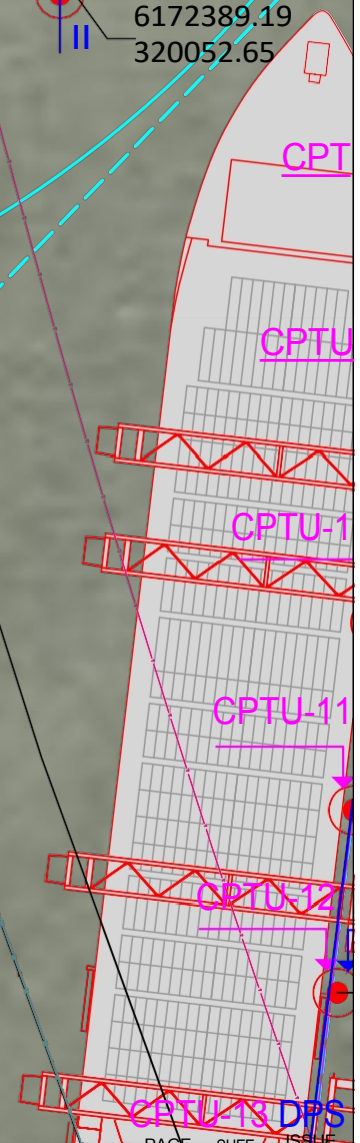

Scale 1:2000		PAGE	SHEET	ISSUE
24094-GT1		5	9	Gr 061 32

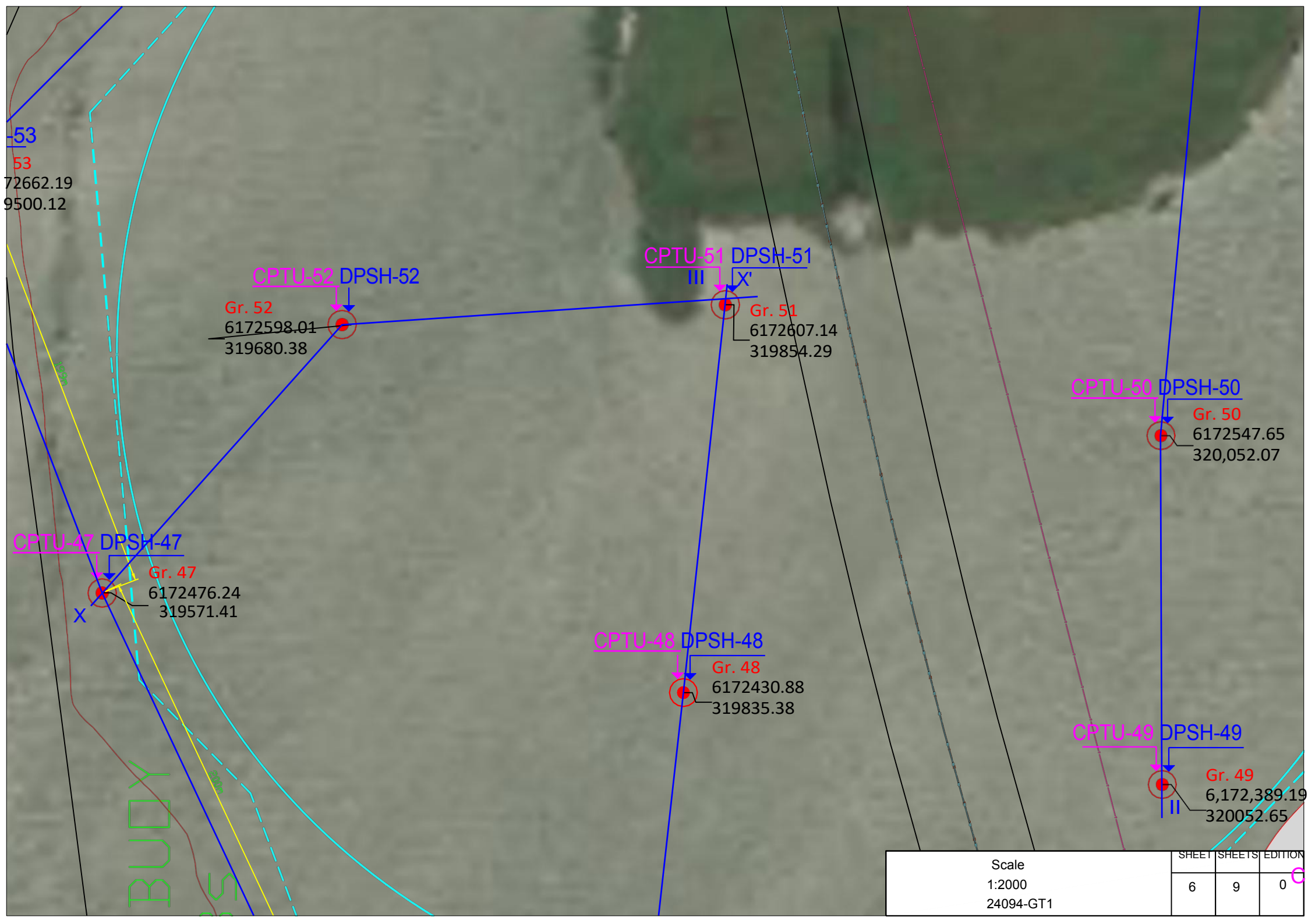

53

53

72662.19

9500.12

CPTU-52 DPSH-52

Gr. 52
6172598.01
319680.38

CPTU-51 DPSH-51

III ↓ X'

Gr. 51
6172607.14
319854.29

CPTU-50 DPSH-50

Gr. 50
6172547.65
320,052.07

CPTU-47 DPSH-47

Gr. 47
6172476.24
319571.41
X

CPTU-48 DPSH-48

Gr. 48
6172430.88
319835.38

CPTU-49 DPSH-49

Gr. 49
6,172,389.19
320052.65
II

BUOY
5

Scale 1:2000 24094-GT1	SHEET	SHEETS	EDITION
	6	9	0

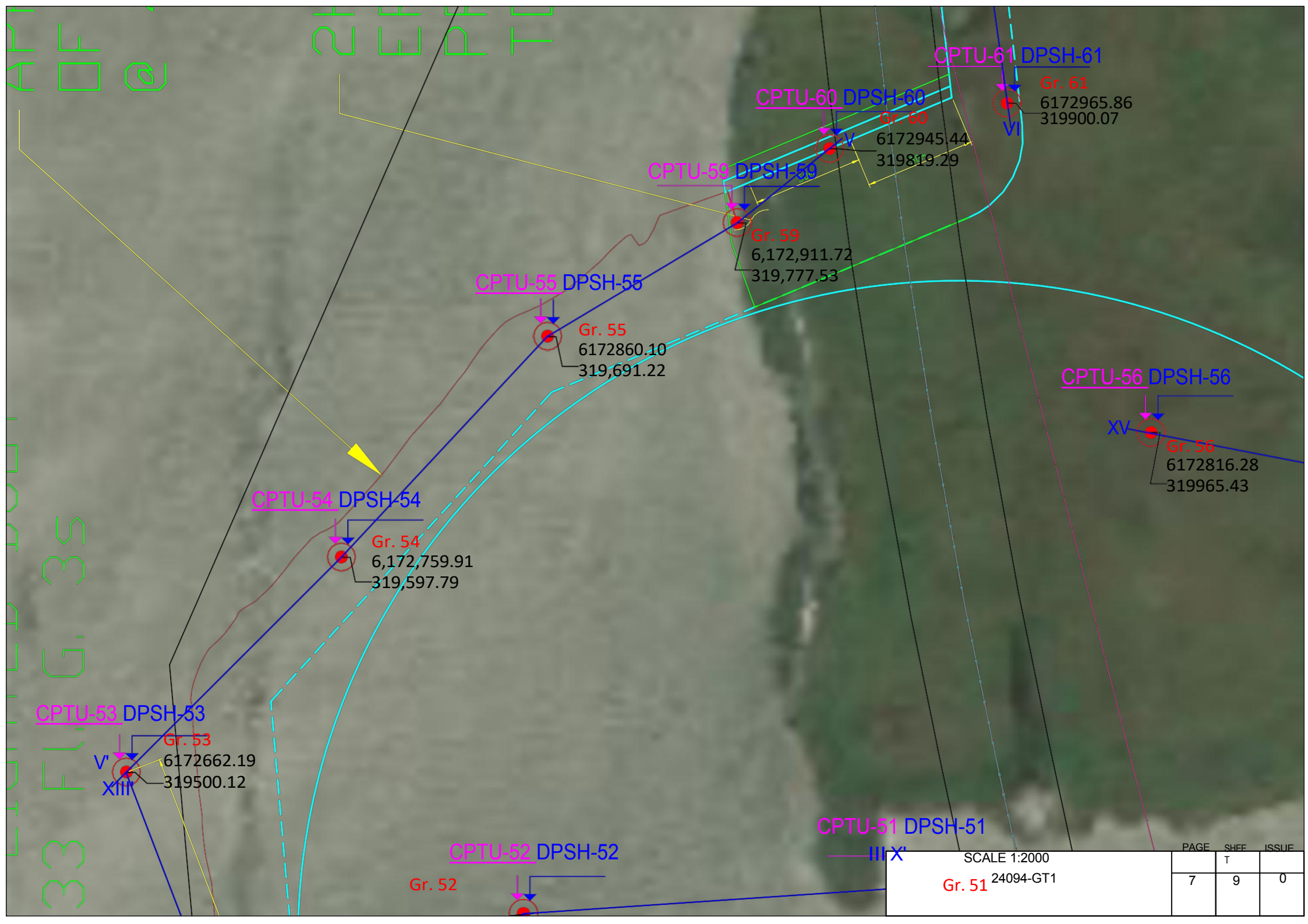

CPTU-53 DPSH-53

Gr. 53
6172662.19
319500.12
V'
XIII

CPTU-54 DPSH-54

Gr. 54
6,172,759.91
319,597.79

CPTU-55 DPSH-55

Gr. 55
6172860.10
319,691.22

CPTU-59 DPSH-59

Gr. 59
6,172,911.72
319,777.53

CPTU-60 DPSH-60

Gr. 60
6172945.44
319819.29

CPTU-61 DPSH-61

Gr. 61
6172965.86
319900.07

CPTU-56 DPSH-56

Gr. 56
6172816.28
319965.43
XV

CPTU-52 DPSH-52

Gr. 52

CPTU-51 DPSH-51

III X'

Gr. 51
24094-GT1

SCALE 1:2000

PAGE	SHEE	ISSUE
7	9	0

CHANNEL
DREDGET
17.0 m

RELOO
NO 2

LIGHT
3M

Gr. 65
6173167.99
319,874.28

CPTU-64 DPSH-64

Gr. 64
6173118.21
319870.42

CPTU-63 DPSH-63

Gr. 63
6173067.88
319,873.88

CPTU-62 DPSH-62

Gr. 62
6,173,038.36
319,890.09

CPTU-61 DPSH-61

Gr. 61
6172965.86
319900.07

CPTU-60 DPSH-60

Gr. 60
6172945.44
319819.29

CPTU-59 DPSH-59

Gr. 59
6172911.72
319,777.53

CPTU-58 DPSH-58

Gr. 58
6172994.38
320098.32

CPTU-56 DPSH-56

Gr. 56
6172816.28
319965.43

CPTU-57 DPSH-57

Gr. 57
6,172,795.32
320074.87

Scale
1:2000
24094-GT1

SHEET	SHEETS	EDITION
8	9	0

TO - 1M

CPTU-68 DPSH-68

VI Gr. 68
6173317.41
319885.24

CPTU-67 DPSH-67

Gr. 67
6173268.06
319,881.68

CPTU-66 DPSH-66

Gr. 66
6,173,237.23
319,879.39

CPTU-65 DPSH-65

Gr. 65
6173167.99
319,874.28

CPTU-64 DPSH-64

Gr. 64
6173118.21
319,870.42

CPTU-63 DPSH-63

Gr. 63
6173067.88
319,873.88

CPTU-62 DPSH-62

Gr. 62
617,303.86
319,890.09

CPTU-61 DPSH-61

CPTU-58 DPSH-58

RELOCATE LIGHTED
NO 29 FL. G. 35

CHANNEL
DREDGE TO
17.0 m

	M :520800		
	264107942-9G9T14.38		

PAGE PAGES ISSUE

9 9 0